

## Countersink Straight Shanks (English)

The LINK countersink features an 82° angle to allow sufficient clearance for drilling and chamfering for flat head and oval head screws. They have a straight shank for standard chucking or a collet holder.

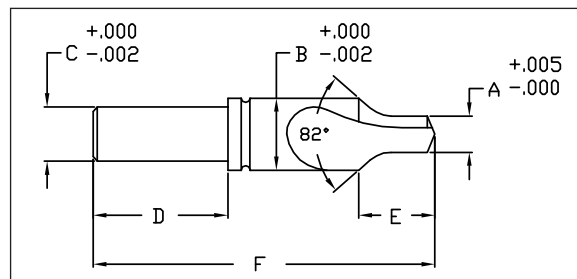

| Part No.  |           |           | English Screw | 82° Angle     |              |               |                  |                  |         |  |
|-----------|-----------|-----------|---------------|---------------|--------------|---------------|------------------|------------------|---------|--|
| HSS       | HSS - TiN | COBALT    |               | Drill DIA (A) | Body DIA (B) | Shank DIA (C) | Shank Length (D) | Drill Length (E) | OAL (F) |  |
| 55-L2-189 | 55-TN-189 | -         | #5            | .127          | 5/16         | 1/4           | 5/8              | 11/32            | 1-3/4   |  |
| 55-L2-190 | 55-TN-190 | 55-CO-190 | #6            | .140          | 5/16         | 1/4           | 5/8              | 11/32            | 1-3/4   |  |
| 55-L2-191 | 55-TN-191 | 55-CO-191 | #8            | .166          | 7/16         | 1/4           | 5/8              | 15/32            | 2       |  |
| 55-L2-192 | 55-TN-192 | 55-CO-192 | #10           | .192          | 7/16         | 1/4           | 5/8              | 15/32            | 2       |  |
| 55-L2-193 | 55-TN-193 | 55-CO-193 | #12           | .220          | 7/16         | 1/4           | 5/8              | 1/2              | 2       |  |
| 55-L2-194 | 55-TN-194 | 55-CO-194 | 1/4           | .252          | 1/2          | 3/8           | 15/16            | 17/32            | 2-3/8   |  |
| 55-L2-195 | 55-TN-195 | 55-CO-195 | 5/16          | .315          | 5/8          | 3/8           | 15/16            | 21/32            | 2-5/8   |  |
| 55-L2-196 | 55-TN-196 | 55-CO-196 | 3/8           | .378          | 3/4          | 1/2           | 1-1/8            | 25/32            | 3       |  |
| 55-L2-197 | 55-TN-197 | -         | 1/2           | .503          | 1            | 1/2           | 1-1/8            | 1-1/64           | 3       |  |
| 55-L2-198 | 55-TN-198 | -         | 5/8           | .625          | 1-1/8        | 1/2           | 1-1/4            | 1-5/32           | 3-1/2   |  |