

Centerdrill ST Type

The ST Type Centerdrill is our standard drill featuring a 60° angle design. This drill is ideal for centering parts to be turned between centers. Snap Ring grooves are offered in HSS, standard drill sizes #4 thru #8; please refer to our Technical Information page to learn more about their function.

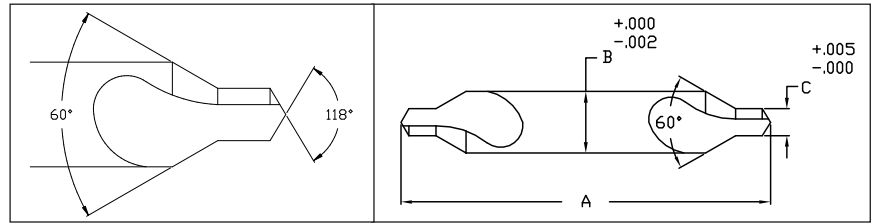

Drill Type	Part No.								OAL (A)	Body DIA (B)	Drill DIA (C)
	HSS	HSS-TiN	HSS-TiAlN	HSS-LH	COBALT	COBALT-TiN	COBALT-Ti-AlN	T15			
00ST	20-L2-090	-	-	-	-	-	-	-	1-1/4	1/8	.025
OST	20-L2-091	-	-	11-L2-091	20-CO-091	-	-	-			1/32
1ST	20-L2-092	-	-	11-L2-092	20-CO-092	-	-	-			3/64
1ST3	20-L2-113	-	-	11-L2-113	20-CO-113	-	-	-	3	3/16	5/64
1ST4	20-L2-114	-	-	11-L2-114	20-CO-114	-	-	-	4		
1ST5	20-L2-115	-	-	11-L2-115	20-CO-115	-	-	-	5		
1ST6	20-L2-116	-	-	-	20-CO-116	-	-	-	6		
2ST	20-L2-093	20-TN-093	20-TL-093	11-L2-093	20-CO-093	CO-TN-093	CO-TL-093	-	1-7/8		
2ST4	20-L2-117	-	-	11-L2-117	20-CO-117	-	-	-	4		
2ST5	20-L2-118	-	-	11-L2-118	20-CO-118	-	-	-	5		
2ST6	20-L2-119	-	-	-	20-CO-119	-	-	-	6		
3ST	20-L2-094	20-TN-094	20-TL-094	11-L2-094	20-CO-094	CO-TN-094	CO-TL-094	20-T5-094	2	1/4	7/64
3ST4	20-L2-120	-	-	11-L2-120	20-CO-120	-	-	-	4		
3ST5	20-L2-121	-	-	11-L2-121	20-CO-121	-	-	-	5		
3ST6	20-L2-122	-	-	11-L2-122	20-CO-122	-	-	-	6		
4ST	20-L2-095	20-TN-095	20-TL-095	11-L2-095	20-CO-095	CO-TN-095	CO-TL-095	20-T5-095	2-1/8	5/16	1/8
4ST4	20-L2-123	-	-	11-L2-123	20-CO-123	-	-	20-T5-123	4		
4ST5	20-L2-124	-	-	11-L2-124	20-CO-124	-	-	-	5		
4ST6	20-L2-125	-	-	11-L2-125	20-CO-125	-	-	-	6		
45ST	20-L2-049	-	-	-	-	-	-	-	2-1/2	3/8	9/64
45ST4	20-L2-126	-	-	11-L2-126	-	-	-	-	4		
45ST5	20-L2-127	-	-	11-L2-127	-	-	-	-	5		
45ST6	20-L2-128	-	-	11-L2-128	-	-	-	-	6		
5ST	20-L2-096	20-TN-096	20-TL-096	11-L2-096	20-CO-096	CO-TN-096	CO-TL-096	20-T5-096	2-3/4	7/16	3/16
5ST5	20-L2-129	-	-	11-L2-129	-	-	-	-	5		
5ST6	20-L2-130	-	-	11-L2-130	20-CO-130	-	-	-	6		
6ST	20-L2-097	20-TN-097	20-TL-097	11-L2-097	20-CO-097	CO-TN-097	CO-TL-097	20-T5-097	3	1/2	7/32
6ST5	20-L2-131	-	-	11-L2-131	-	-	-	-	5		
6ST6	20-L2-132	-	-	11-L2-132	20-CO-132	-	-	-	6		
7ST	20-L2-098	20-TN-098	20-TL-098	11-L2-098	20-CO-098	CO-TN-098	CO-TL-098	20-T5-098	3-1/4	5/8	1/4
7ST6	20-L2-133	-	-	11-L2-133	-	-	-	-	6		
8ST	20-L2-099	20-TN-099	20-TL-099	11-L2-099	20-CO-099	CO-TN-099	CO-TL-099	20-T5-099	3-1/2	3/4	5/16
8ST6	20-L2-134	-	-	11-L2-134	-	-	-	-	6		
9ST	20-L2-136	-	-	-	-	-	-	-	3-5/8	7/8	11/32
10ST	20-L2-135	-	-	-	-	-	-	-	3-3/4	1	3/8

