

Centerdrill 90° and 100° Type

Similar to our standard ST Type Centerdrill, these drills feature either a 90° or 100° angle design.

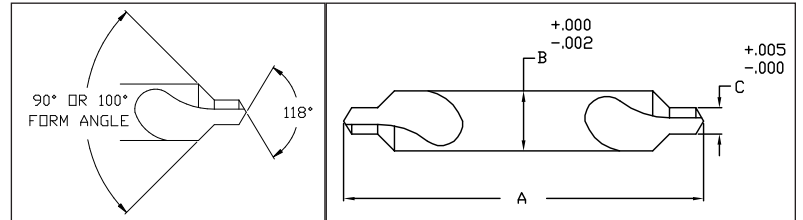

| Drill Size | Part Number | | OAL (A) | Body DIA (B) | Drill DIA (C) |
|------------|-------------|--------------|---------|--------------|---------------|
| | HSS - 90° | COBALT - 90° | | | |
| 0-90 | 10-90-001 | 90-CO-001 | 1-1/4 | 1/8 | 1/32 |
| 1-90 | 10-90-002 | 90-CO-002 | | | 3/64 |
| 2-90 | 10-90-003 | 90-CO-003 | 1-7/8 | 3/16 | 5/64 |
| 3-90 | 10-90-004 | 90-CO-004 | 2 | 1/4 | 7/64 |
| 4-90 | 10-90-005 | 90-CO-005 | 2-1/8 | 5/16 | 1/8 |
| 5-90 | 10-90-006 | 90-CO-006 | 2-3/4 | 7/16 | 3/16 |
| 6-90 | 10-90-007 | 90-CO-007 | 3 | 1/2 | 7/32 |
| 7-90 | 10-90-008 | 90-CO-008 | 3-1/4 | 5/8 | 1/4 |
| 8-90 | 10-90-009 | 90-CO-009 | 3-1/2 | 3/4 | 5/16 |

| Drill Size | Part Number | | OAL (A) | Body DIA (B) | Drill DIA (C) |
|------------|-------------|---------------|---------|--------------|---------------|
| | HSS - 100° | COBALT - 100° | | | |
| 0-100 | 10-100-001 | 100-CO-001 | 1-1/4 | 1/8 | 1/32 |
| 1-100 | 10-100-002 | 100-CO-002 | | | 3/64 |
| 2-100 | 10-100-003 | 100-CO-003 | 1-7/8 | 3/16 | 5/64 |
| 3-100 | 10-100-004 | 100-CO-004 | 2 | 1/4 | 7/64 |
| 4-100 | 10-100-005 | 100-CO-005 | 2-1/8 | 5/16 | 1/8 |
| 5-100 | 10-100-006 | 100-CO-006 | 2-3/4 | 7/16 | 3/16 |
| 6-100 | 10-100-007 | 100-CO-007 | 3 | 1/2 | 7/32 |
| 7-100 | 10-100-008 | 100-CO-008 | 3-1/4 | 5/8 | 1/4 |
| 8-100 | 10-100-009 | 100-CO-009 | 3-1/2 | 3/4 | 5/16 |